

January 23, 2017
WO 3915

City of Auburn
Mechanics Row Garage Phase 3 Repairs – Addendum 1

Item #1 Question: Under the warranty – General Conditions, it states 5 years. The sample contract states 1. Which one is it?

Answer: A 5 year warranty should be provided to the City. Under the “Sample Contract” item #5 should be revised to read “The CONTRACTOR shall guarantee his work against any defects in workmanship and materials for a period of five years from the date of the CITY’s written acceptance of the project.”

Item #2 Sketch SK-1 It was brought to the attention to the City that an overhead spall had formed at the precast double T chord connections at Level 1 within the proposed Phase 3 work area. The attached sketch outlines the location and proposed repair.

Item #3 Revised Bid Form The attached revised bid form reflects the increased quantity of “CIP/PC Deck Repair” due to the overhead spall repair detailed above in Item #2.

Attachments:

Sketch SK-1
Revised Bid Form

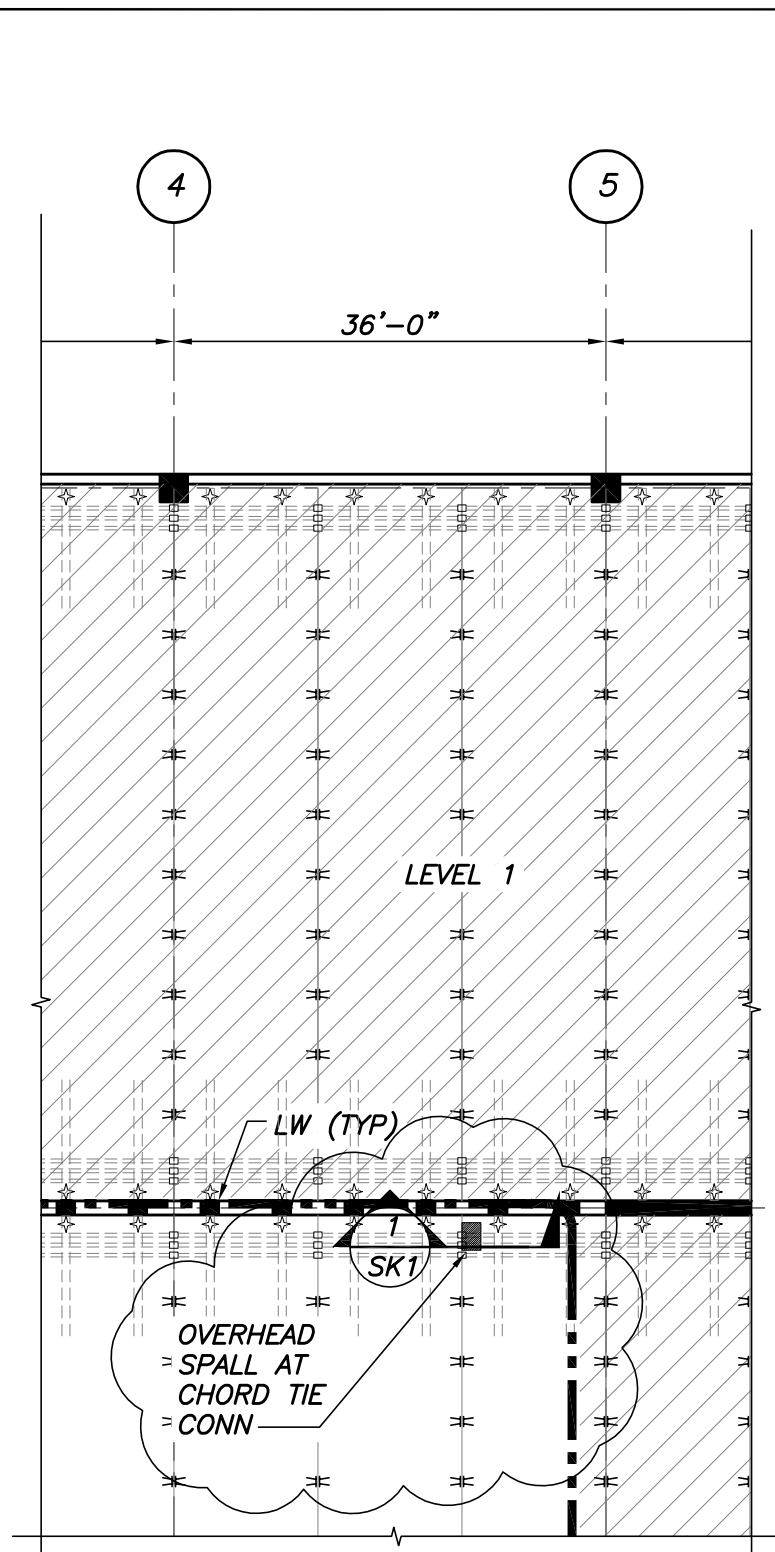

LEVEL 1 PARTIAL PLAN

1/16"=1'-0"

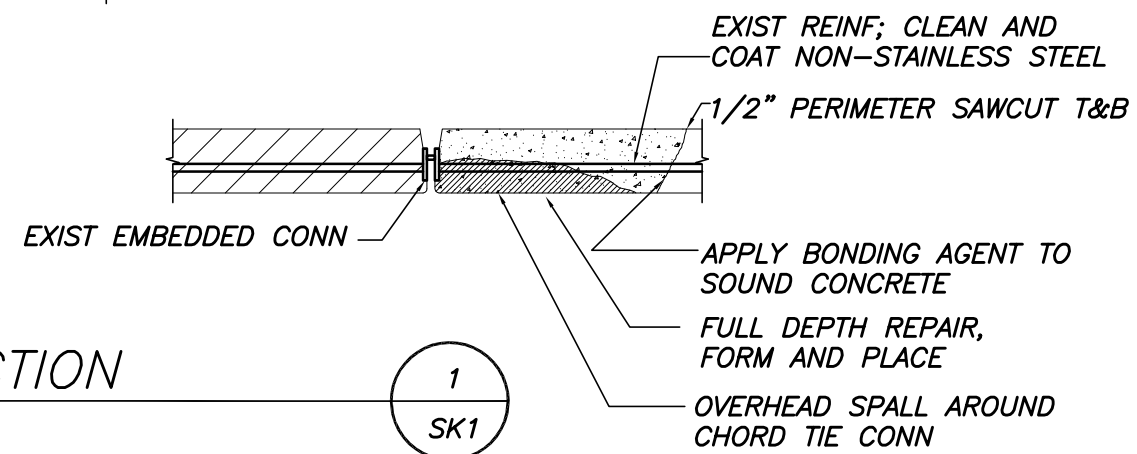
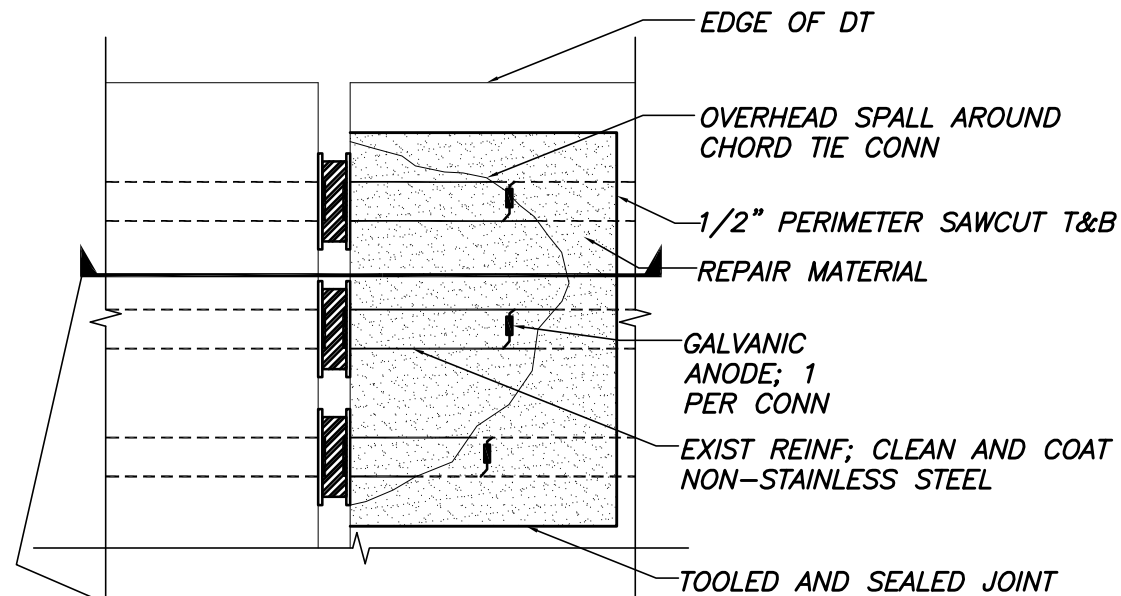

SECTION

N.T.S.

NOTES:

PREPARATION/INSPECTION:

1. SOUND OUT DETERIORATED CONCRETE.
2. PROVIDE 1/2" DEEP SAWCUT ALONG PERIMETER OF REMOVAL AREA AT TOP AND BOTTOM OF PRECAST FLANGE.
3. REMOVE DETERIORATED CONCRETE UNTIL SOUND CONCRETE IS REACHED AND CORROSION ON REINFORCEMENT IS NOT VISIBLE.
4. ALLOW ENGINEER TO REVIEW EXPOSED CONDITION PRIOR TO FORMWORK BEING INSTALLED.

REPAIR:

1. CLEAN ALL STEEL SURFACES REMOVING ALL RUST, SCALE AND DETERIORATED COATING TO SSPC-SP3 (POWER TOOL CLEAN).
2. ALL NON-STAINLESS STEEL REINFORCEMENT SHALL BE PRIMED OR EPOXY COATED WITH A PRODUCT COMPATIBLE WITH THE CONCRETE REPAIR MATERIAL.
3. FORM WORK SHALL BE DESIGNED AND CONSTRUCTED TO SUPPORT THE REPAIR MATERIALS AND VEHICLE LOADS IF REQD.
4. FORMS SHALL BE CONSTRUCTED TO FIT TIGHTLY AGAINST EXISTING CONCRETE SURFACES.
5. REPAIR AREA SHALL BE COMPLETED WITH A PRE-PACKAGED MATERIAL WITH SHRINKING COMPENSATING AND CORROSION INHIBITING ADDITIVES.
6. PROVIDE TOOLED JOINT AROUND REPAIR PERIMETER AREA AND SEAL WITH SEALANT.
7. MATERIAL SHALL BE PLACED AS PER SPECIFICATIONS AND PER MANUFACTURERS RECOMMENDATIONS.
8. FORM WORK, SHORING AND TEMPORARY PROTECTION SHALL REMAIN IN-PLACE UNTIL MATERIAL ACHIEVES A MINIMUM STRENGTH OF $f'_c=4,000$ PSI MIN.

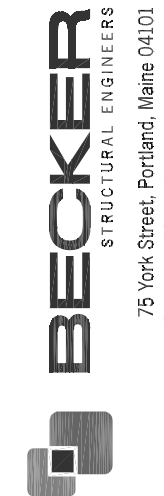

75 York Street, Portland, Maine 04101
207.879.1838 • beckerstructural.com

MECHANICS ROW PARKING GARAGE

PHASE 3 REPAIRS

OVERHEAD SPALL REPAIR

Designed ATS	Scale AS NOTED
Drawn ATS	Date 1/23/17
Checked JMM	Becker Job Number 3915

SK1

BID FORM

A. GENERAL CONDITONS: For all Work other than the Unit Price Work listed in sections B (Including but not limited to all mobilization/demobilization, required permits, temporary shoring, temporary enclosures and protection, ventilation, temporary traffic control, signage, heat and utilities, etc.), a Lump Sum of:

_____ \$
(words) (numerals)

B. UNIT PRICE WORK (see table below)

UNIT PRICE WORK

ITEM	DESCRIPTION	UNIT	QNTY	UNIT COST	TOTAL COST
1	DT-DT shear connection repair	ea	55		
2	DT connection pocket repair	ea	52		
3	Overhead connection repair	ea	3		
4	Joint & cove sealant replacement	lf	1,150		
5	Overhead supplemental steel connection	ea	5		
6	CIP/PC deck repair	sf	55		
7	Standard duty traffic membrane	sf	430		
8	Crack chase	lf	200		
9	Concrete sealer over IT beam	sf	90		
10	Exposed DT flange reinforcement repair	ea	10		
	Unit Price Total				

C. TOTAL ESTIMATED BID AMOUNT OF (Items A + B):

_____ \$
(words) (numerals)

Company Name: _____
Signed by: _____
Title: _____
Print Name: _____
Address: _____
Tel. # _____ Fax # _____
Date: _____

**Mechanics Row Parking Garage
Phase 3 Repairs
Auburn, Maine**

The following unit prices are required for the Owner to evaluate additions to or deductions from the work:

ITEM	DESCRIPTION	UNIT	Addition Unit Price	Deduction Unit Price
1	DT-DT shear connection repair	ea		
2	DT connection pocket repair	ea		
3	Overhead connection repair	ea		
4	Joint & cove sealant replacement	lf		
5	Overhead supplemental steel connection	ea		
6	CIP/PC deck repair	sf		
7	Standard duty traffic membrane	sf		
8	Crack chase	lf		
9	Concrete sealer over IT beam	sf		
10	Exposed DT flange reinforcement repair	ea		